



## WL16-RS Specification Sheet

# WL16-RS Cotswold

Patent Pending

## FEATURES

- Lifetime Warranty
- UL Listed
- Constructed For Extreme Conditions
- Eco-Efficient LED Technology
- Available in Custom Colors & Finishes
- Available Only Through ClaroLux Installation Professionals

## APPLICATIONS

- Uplighting Trees & Architectural Features
- Designed For Concrete & Level Landscape Surfaces
- Ideal For High Traffic & Commercial Locations

## QUICK SPECS

- MR16
- Max Wattage: 20W
- Wire AWG: 18-2
- Wire Lead: 10ft
- UL Listed: USA & Canada
- Warranty: Lifetime

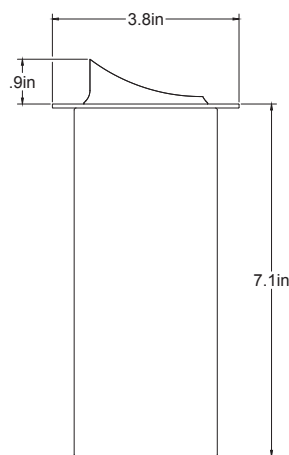

## OPTIONAL ACCESSORIES

For a list of optional accessories speak with your professional ClaroLux installer.

## AVAILABLE FINISHES



Rev 8.1 | 1.24

Designed, CNC Machined, Finished and Assembled in America with US and Global Components  
Factory Direct • Professional Grade • Landscape Lighting Fixtures, Supplies and Accessories

2501 Greengate Drive | Greensboro, NC 27406 | [ClaroLux.com](http://ClaroLux.com)